



MIR-AUS

Tel: 02 80655614

1300 213 589

www.mir-aus.com

www.mir-aus.com.au

info@mir-aus.com

INSTALLATION INSTRUCTIONS

PREPARING THE MBOX V.2 TANKS



CISS MBOX V.2

1. Keep out of reach of children. Seek medical advice if taken.
2. Avoid exposure to direct sunshine and don't keep it at high or freezing temperatures.
3. Avoid Knocks and bumps.
4. Please avoid taking out the cartridges after installing the CIS ink system, where possible.
5. This product is designed to operate within 10-40 degrees Celsius.
6. The CIS ink system has passed strict compatibility check, so we suggest using our ink and cartridges to maintain printer quality.
7. Mixing two different brands of ink into the CISS is not recommended
- 8. Keep the tank and printer at the same level. Do not place the tanks higher or lower than their printer.**

Thank you for purchasing the MIR-AUS Continuous Ink Supply System (CISS). We appreciate your support and will try our best to make your experience with our products a pleasant one. Printing has been a different experience ever since you installed MIR-AUS Continuous Ink Supply system on your own printer. Just imagining being able to print without regard to the ink level in those expensive little cartridges.

Please take your time installing MIR-AUS Continuous Ink Supply system. Do not remove your old cartridge until you have the MIR-AUS CIS system primed and ready to install (to prevent the drying of heads). In addition, make sure you are getting perfect nozzle checks before installing the MIR-AUS CIS system. The MIR-AUS CIS system won't be able to work properly if the nozzles are previously clogged.

Most people get a perfect nozzle check the first time after installing the MIR-AUS Continuous Ink Supply system; others may need to run two or three cleaning cycles or let the printer sit for a while before they get the perfect results.

Please take a moment to read the important installation and use instructions below.

Your CISS consists of two parts:

- A tank unit containing a number of tanks, each storing ink to feed your cartridges, which will sit along-side your printer.
- A set of cartridges (the number of cartridges will equal to the number of tanks in your tank unit), which will be inserted into your printer.
- An ink pipeline connects the tank unit to the set of cartridges.

Continuous Ink Supply System

CISS MBOX-V.2
120ml
Capacity
for each colour



CISS MBOX-V.2



Before installing your CISS you must create an appropriate air balance inside each tank. The shipping will have caused the ink to move inside the tanks and you can easily remedy this by following the installation instructions below.

Preparing the MBOX V.2 tanks

(after install the cartridges please do this step)



1. Turn the tanks onto their side.
2. Remove each top cover by inserting your finger under the tab and lifting the cover off. You will see the names of the colours facing up on each tank.
3. Using your finger and thumb in a tissue, remove each 'travel plug' and keep them in a safe place. (The tissue will prevent any drops of ink from getting on your fingers). If you travel with the unit you'll need to put them back in for the travel and then remove them again to use the CISS. Also, if you plan not to use the printer for more than one month, it is a good idea to put the plugs back in and take them out again when you want to use the printer. This is to protect the ink closest to the plug holes.
4. Leave the tanks on their side for 3 seconds to create the appropriate air balance you'll need to operate the CISS. This air balance is important for the flow of the ink from the tanks to the cartridges
5. Put the covers back onto each tank. The covers are important to protect the high quality ink from exposure to light
6. Sit the tanks back up but be careful never to knock the tanks over onto their plug-hole side as if you lay them down on this side, ink will escape from the open plug-holes. For this reason it is important to sit the tanks to the side of your printer (but level with the printer) in an area where you won't knock it over

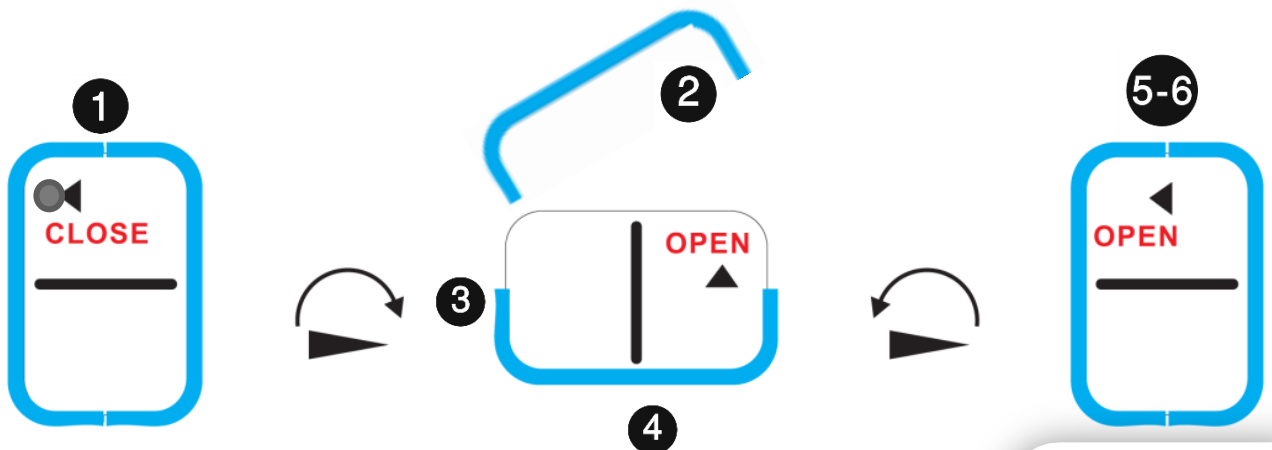

Remove each 'travel plug'

