

CISS Installation Manual

Product:

XP-600 , XP-700 , XP-800



Installation:

Use for EPSON XP-60 , XP-700 , XP-800

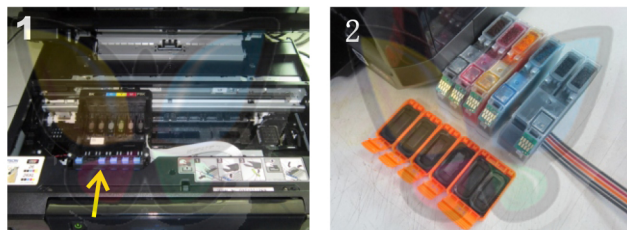

1-Turn on the printer and select "Replacing and ink cartridge" then the ink cartridge's comes to the replacement position.

2-Remove the orange cap from the bottom of the cartridges.

3- Install the CISS cartridges, make sure insert correctly.

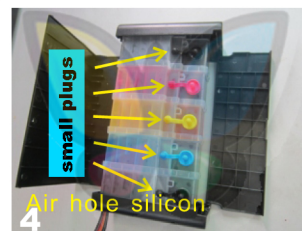
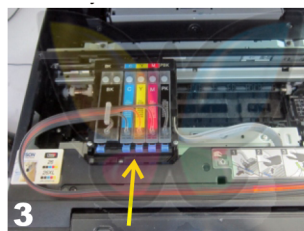

4-5 - Open The Small Plugs, (need to be left open all time).

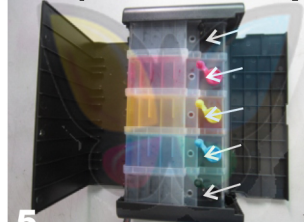

6- Close the external ink tank, as shown.

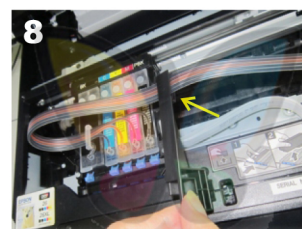
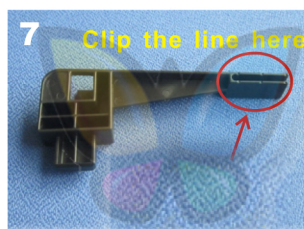

7-8 Use the tubing holder and install as shown.

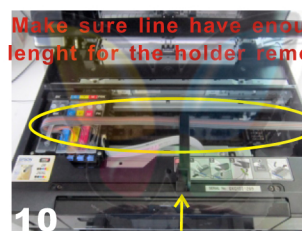

9-10 Insert tubing holder into the door sensor, as yellow arrow point shown.

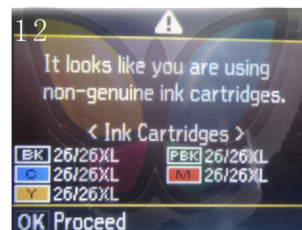
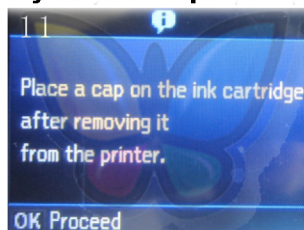

11- 12 - When you see this two messages press "OK".

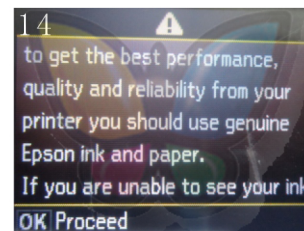
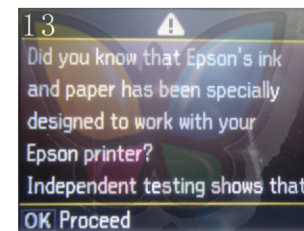

13- 14 - When you see this two messages press "OK".

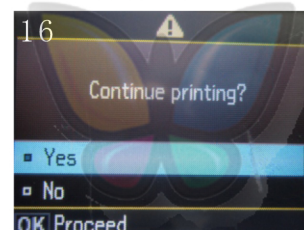
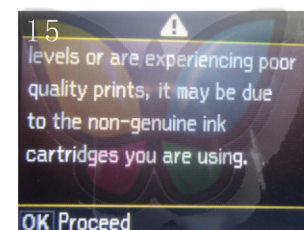

15- 16 - When you see this two messages press "OK".

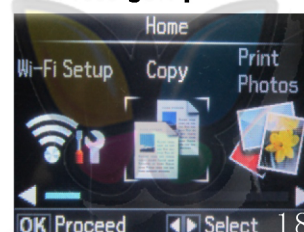
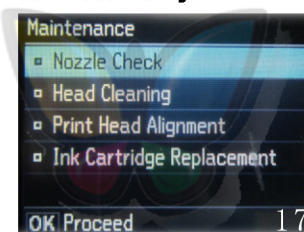

17- Select "Nozzle Check"



19- Use extra tubing holder on the printer side



21- Close the scanner cover and open the roller locker