



MIR-AUS

Tel: 02 80655614

1300 213 589

www.mir-aus.com

www.mir-aus.com.au

info@mir-aus.com

INSTALLATION INSTRUCTIONS FOR ALL HP 88 / 18 CARTRIDGES

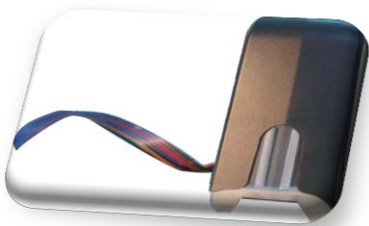

CISS FLY V.3



CISS MBOX V.2

1. Keep out of reach of children. Seek medical advice if taken.
2. Avoid exposure to direct sunshine and don't keep it at high or freezing temperatures.
3. Avoid Knocks and bumps.
4. Please avoid taking out the cartridges after installing the CIS ink system, where possible.
5. This product is designed to operate within 10-40 degrees Celsius.
6. The CIS ink system has passed strict compatibility check, so we suggest using our ink and cartridges to maintain printer quality.
7. Mixing two different brands of ink into the CISS is not recommended
- 8. Keep the tank and printer at the same level. Do not place the tanks higher or lower than their printer.**

This Version of the Continuous Ink Flow System comes with Prefilled Cartridges and Auto Reset Chips. You just need to fill the Reservoir bottles and print! The whole operation is very easy. It's really an effective tool to save your money.

Thank you for purchasing the MIR-AUS Continuous Ink Supply System (CISS). We appreciate your support and will try our best to make your experience with our products a pleasant one. Printing has been a different experience ever since you installed MIR-AUS Continuous Ink Supply system on your own printer. Just imagining being able to print without regard to the ink level in those expensive little cartridges.

Please take your time installing MIR-AUS Continuous Ink Supply system. Do not remove your old cartridge until you have the MIR-AUS CIS system primed and ready to install (to prevent the drying of heads). In addition, make sure you are getting perfect nozzle checks before installing the MIR-AUS CIS system. The MIR-AUS CIS system won't be able to work properly if the nozzles are previously clogged.

Most people get a perfect nozzle check the first time after installing the MIR-AUS Continuous Ink Supply system; others may need to run two or three cleaning cycles or let the printer sit for a while before they get the perfect results.

Please take a moment to read the important installation and use instructions below.

Your CISS consists of two parts:

- A tank unit containing a number of tanks, each storing ink to feed your cartridges, which will sit along-side your printer.
- A set of cartridges (the number of cartridges will equal to the number of tanks in your tank unit), which will be inserted into your printer.
- An ink pipeline connects the tank unit to the set of cartridges.



Before installing your CISS you must create an appropriate air balance inside each tank. The shipping will have caused the ink to move inside the tanks and you can easily remedy this by following the installation instructions below.

Preparing the MBOX V.2 tanks

(after install the cartridges please do this step)



1. Turn the tanks onto their side.
2. Remove each top cover by inserting your finger under the tab and lifting the cover off. You will see the names of the colours facing up on each tank.
3. Using your finger and thumb in a tissue, remove each 'travel plug' and keep them in a safe place. (The tissue will prevent any drops of ink from getting on your fingers). If you travel with the unit you'll need to put them back in for the travel and then remove them again to use the CISS. Also, if you plan not to use the printer for more than one month, it is a good idea to put the plugs back in and take them out again when you want to use the printer. This is to protect the ink closest to the plug holes.
4. Leave the tanks on their side for 3 seconds to create the appropriate air balance you'll need to operate the CISS. This air balance is important for the flow of the ink from the tanks to the cartridges
5. Put the covers back onto each tank. The covers are important to protect the high quality ink from exposure to light
6. Sit the tanks back up but be careful never to knock the tanks over onto their plug-hole side as if you lay them down on this side, ink will escape from the open plug-holes. For this reason it is important to sit the tanks to the side of your printer (but level with the printer) in an area where you won't knock it over

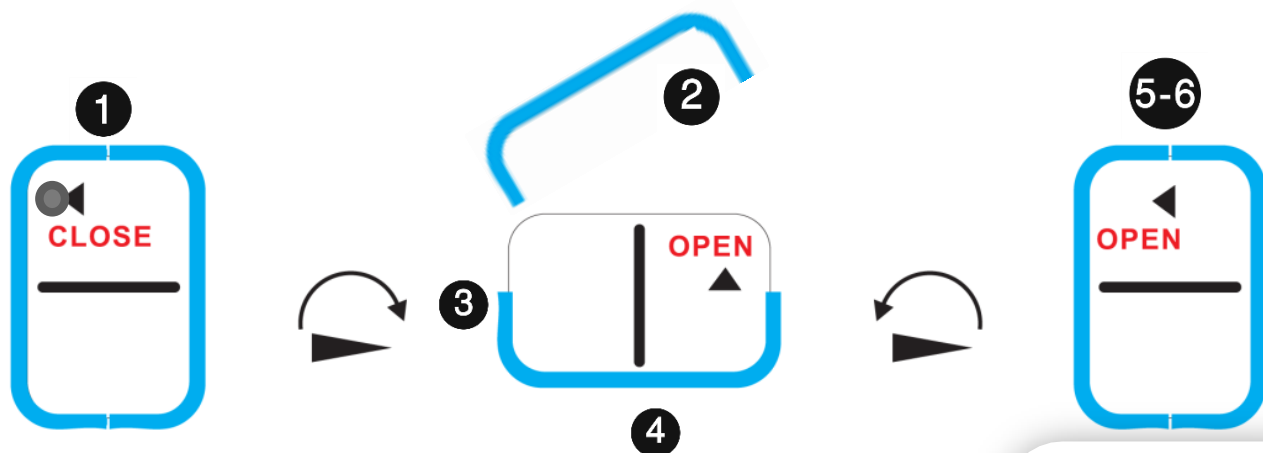

Remove each 'travel plug'

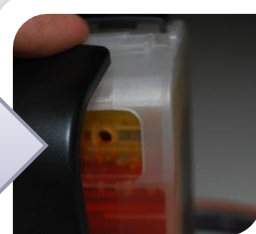

Before installing your CISS you must create an appropriate air balance inside each tank. The shipping will have caused the ink to move inside the tanks and you can easily remedy this by following the installation instructions below.

Preparing the FLY V.3 tanks

(after install the cartridges please do this step)



Remove all the plugs from the tanks.

(But don't remove the plugs from the cartridges)

Each Fly CISS tank has 2 separate compartments:

a reserve ink compartment (where ink is stored to be fed into the air balance compartment. This is the wider of the two compartments)

an air balance compartment (which is always mostly empty. This is the narrower of the two compartments)

When you first install a CISS unit into your printer (and before using it), you must create an appropriate air balance inside your tank.

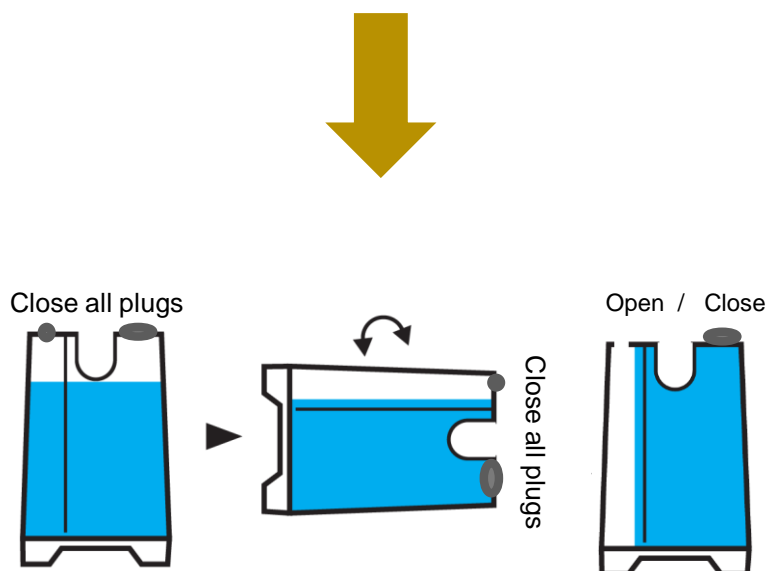

Trouble shooting for CISS FLY V.3:

It is very important that there is mostly air in the air balance compartment (so not more than 2cm of ink).

After shipping and handling, if there is more than 2 cm of ink in the air balance compartment, make sure the holes are plugged and sit the unit on its side (reserve ink compartment side down) for five seconds or so to let the ink drain out of the air balance compartment into the reserve ink compartment. See the photos below.

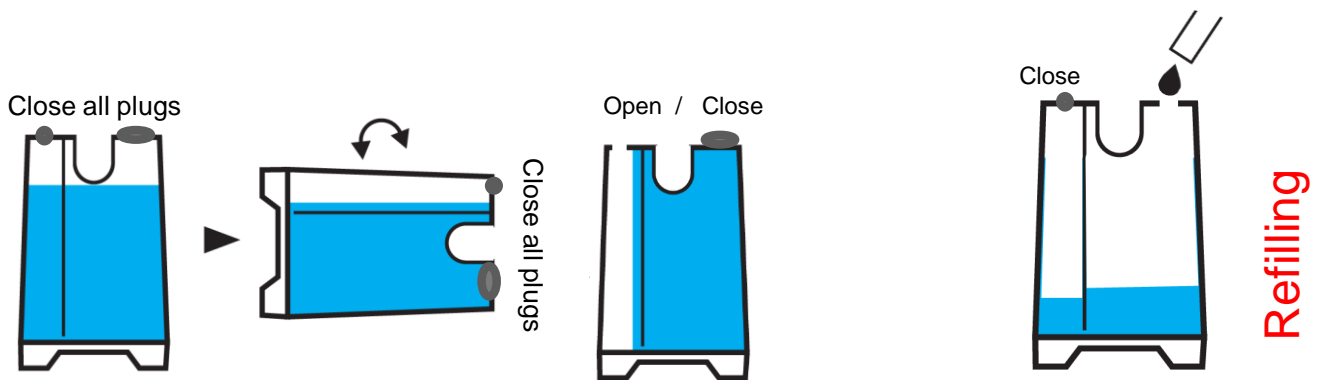

Notes:

1. your system will automatically find the correct balance of ink for the air balance compartment (to give the CISS the correct air pressure so don't worry about the actual level- it may be between 0.5cm and 1.5cm approximately)

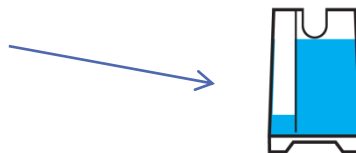

2. after using your CISS for some time please check the level of the ink in the reserve ink compartment. If it is below 2cm it is now time to order more ink and refill the compartment. (check out our website for very inexpensive high quality ink). It is important to keep using the same ink in your system. Adding another brand of ink which mixes with your existing ink in the system can block the printer nozzle.

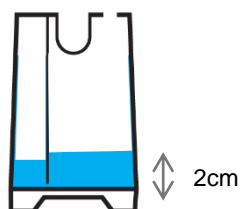



1. Pull the power plug for your printer out of the wall. Next, open the cartridge door and remove the original cartridges. Put the CIS on the side of the printer. Insert the CIS cartridges into the slots. Press down on each cartridge firmly to make sure all cartridges are in the locked position.

2. If your model features a cartridge door sensor, insert a small piece of tapered paper into the cartridge door sensor to get the printer to function without closing the door.

3. Pull out the small rubber plug from the air hole of each of the external ink tank chambers. Keep the ink tank placed on the same level as the printer. **If placed above the printer, the cartridges will leak and if placed below the printer, the cartridges will not print.**

4. Plug the printer back in and turn on the power. Run a few cleaning cycles until you have a perfect nozzle pattern. The printer is now ready to use. If you have problems getting a perfect nozzle pattern, let the printer rest overnight, and try again in the morning.

5. If the cartridge indicator light is flashing when printing, you need to reset the chip to full ink level status. Turn off your printer for 10 seconds and switch it back on. The ink monitor is now reset to full. You can start printing as usual.

