



MIR-AUS

Tel: 02 80655614

1300 213 589

www.mir-aus.com

www.mir-aus.com.au

info@mir-aus.com

INSTALLATION INSTRUCTIONS FOR ALL CANON PRINTERS



CISS FLY V.3



CISS MBOX V.2

1. Keep out of reach of children. Seek medical advice if taken.
2. Avoid exposure to direct sunshine and don't keep it at high or freezing temperatures.
3. Avoid Knocks and bumps.
4. Please avoid taking out the cartridges after installing the CIS ink system, where possible.
5. This product is designed to operate within 10-40 degrees Celsius.
6. The CIS ink system has passed strict compatibility check, so we suggest using our ink and cartridges to maintain printer quality.
7. Mixing two different brands of ink into the CISS is not recommended
- 8. Keep the tank and printer at the same level. Do not place the tanks higher or lower than their printer.**

This Version of the Continuous Ink Flow System comes with Prefilled Cartridges and Auto Reset Chips. You just need to fill the Reservoir bottles and print! The whole operation is very easy. It's really an effective tool to save your money.

Thank you for purchasing the MIR-AUS Continuous Ink Supply System (CISS). We appreciate your support and will try our best to make your experience with our products a pleasant one. Printing has been a different experience ever since you installed MIR-AUS Continuous Ink Supply system on your own printer. Just imagining being able to print without regard to the ink level in those expensive little cartridges.

Please take your time installing MIR-AUS Continuous Ink Supply system. Do not remove your old cartridge until you have the MIR-AUS CIS system primed and ready to install (to prevent the drying of heads). In addition, make sure you are getting perfect nozzle checks before installing the MIR-AUS CIS system. The MIR-AUS CIS system won't be able to work properly if the nozzles are previously clogged.

Most people get a perfect nozzle check the first time after installing the MIR-AUS Continuous Ink Supply system; others may need to run two or three cleaning cycles or let the printer sit for a while before they get the perfect results.

Please take a moment to read the important installation and use instructions below.

Your CISS consists of two parts:

- A tank unit containing a number of tanks, each storing ink to feed your cartridges, which will sit along-side your printer.
- A set of cartridges (the number of cartridges will equal to the number of tanks in your tank unit), which will be inserted into your printer.
- An ink pipeline connects the tank unit to the set of cartridges.



Before installing your CISS you must create an appropriate air balance inside each tank. The shipping will have caused the ink to move inside the tanks and you can easily remedy this by following the installation instructions below.

Preparing the MBOX V.2 tanks

(after install the cartridges please do this step)



1. Turn the tanks onto their side.
2. Remove each top cover by inserting your finger under the tab and lifting the cover off. You will see the names of the colours facing up on each tank.
3. Using your finger and thumb in a tissue, remove each 'travel plug' and keep them in a safe place. (The tissue will prevent any drops of ink from getting on your fingers). If you travel with the unit you'll need to put them back in for the travel and then remove them again to use the CISS. Also, if you plan not to use the printer for more than one month, it is a good idea to put the plugs back in and take them out again when you want to use the printer. This is to protect the ink closest to the plug holes.
4. Leave the tanks on their side for 3 seconds to create the appropriate air balance you'll need to operate the CISS. This air balance is important for the flow of the ink from the tanks to the cartridges
5. Put the covers back onto each tank. The covers are important to protect the high quality ink from exposure to light
6. Sit the tanks back up but be careful never to knock the tanks over onto their plug-hole side as if you lay them down on this side, ink will escape from the open plug-holes. For this reason it is important to sit the tanks to the side of your printer (but level with the printer) in an area where you won't knock it over

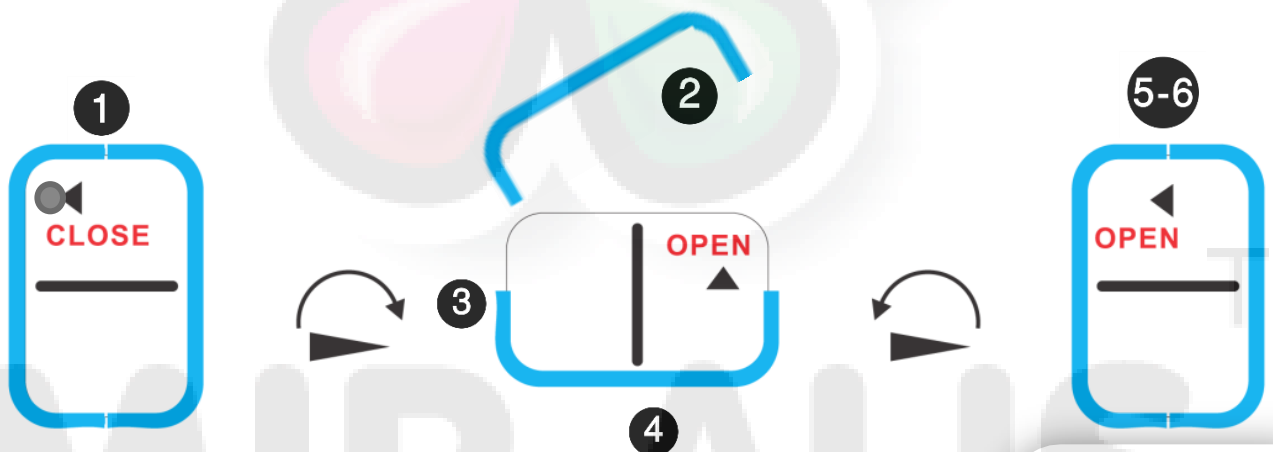

Remove each 'travel plug'



Before installing your CISS you must create an appropriate air balance inside each tank. The shipping will have caused the ink to move inside the tanks and you can easily remedy this by following the installation instructions below.

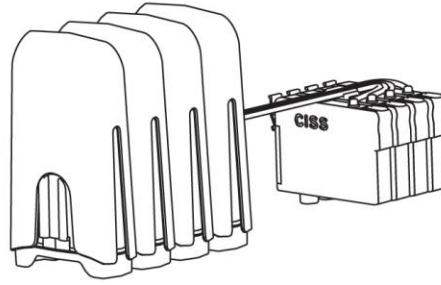

Preparing the FLY V.3 tanks

(after install the cartridges please do this step)

Remove all the small plugs (1) from the tanks.

(But don't remove the plugs from the cartridges)

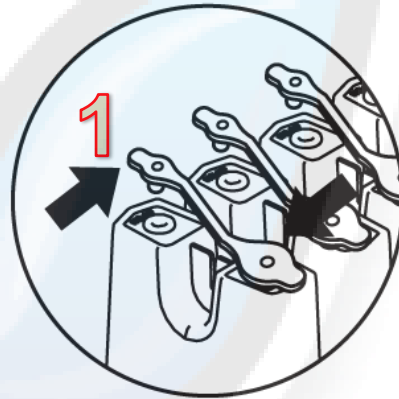
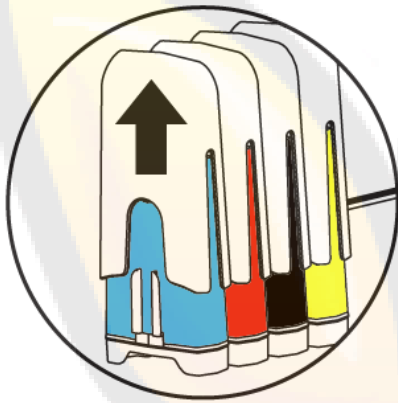

Each Fly CISS tank has 2 separate compartments:
a reserve ink compartment [A] (where ink is stored to be fed into the air balance compartment. This is the wider of the two compartments)
an air balance compartment [B] (which is always mostly empty. This is the narrower of the two compartments)

When you first install a CISS unit into your printer (and before using it), you must create an appropriate air balance inside your tank.

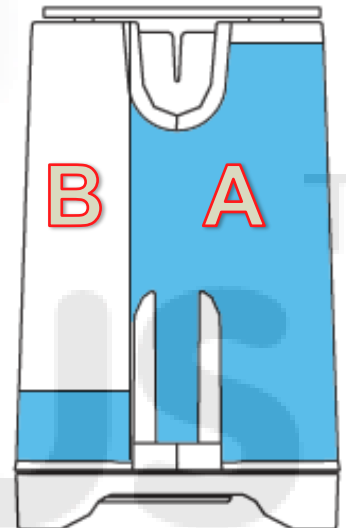

Trouble shooting for CISS FLY V.3:

It is very important that there is mostly air in the air balance compartment (so not more than 2cm of ink).

After shipping and handling, if there is more than 2 cm of ink in the air balance compartment, make sure the holes are plugged and sit the unit on its side (reserve ink compartment side down) for five seconds or so to let the ink drain out of the air balance compartment into the reserve ink compartment. See the photos below.

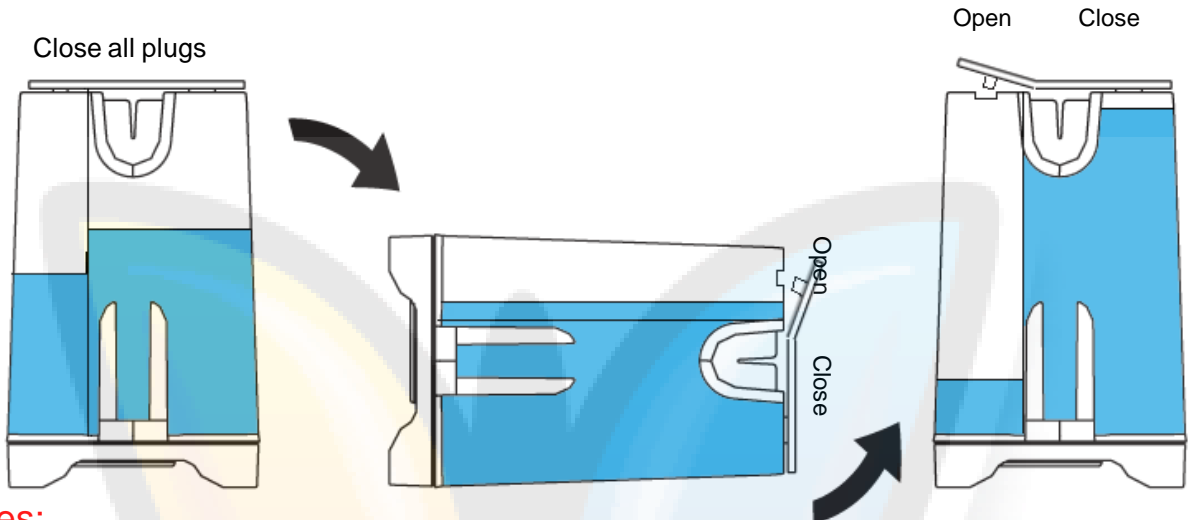

Notes:

1. your system will automatically find the correct balance of ink for the air balance compartment (to give the CISS the correct air pressure so don't worry about the actual level- it may be between 0.5cm and 1.5cm approximately)

1. after using your CISS for some time please check the level of the ink in the reserve ink compartment. If it is below 2cm it is now time to order more ink and refill the compartment. (check out our website for very inexpensive high quality ink). It is important to keep using the same ink in your system. Adding another brand of ink which mixes with your existing ink in the system can block the printer nozzle.

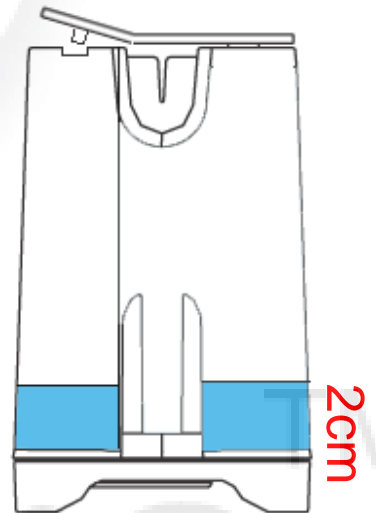

Refilling

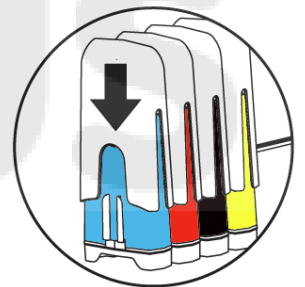
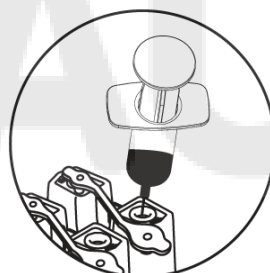
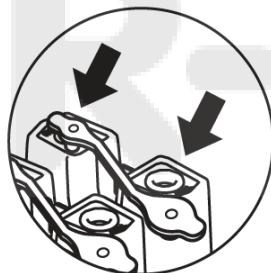
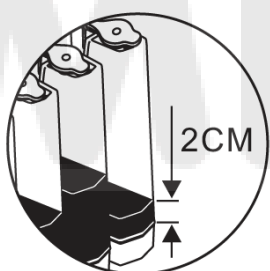

Installing the cartridge unit into the printer

1. Before you do anything with the cartridge, block the flow of ink from the tank unit to the cartridges but placing the pipeline lock into the lock position (as shown).



2. On top of the printer head is a housing unit which will house each of the cartridges you are to install. (Just as if you were installing a Canon original cartridge)

Looking down onto the printer head housing unit, you will see that each house has an ink inlet around which you'll need to attach one of the **silicone** washers (*we've attached inside the lid of your packaging*).

Attach each silicone washer to its inlet using tweezers or clean hands. It is important to attach the silicone washers to prevent any ink from leaking into your printer.

housing unit (ink inlet)



Printer head

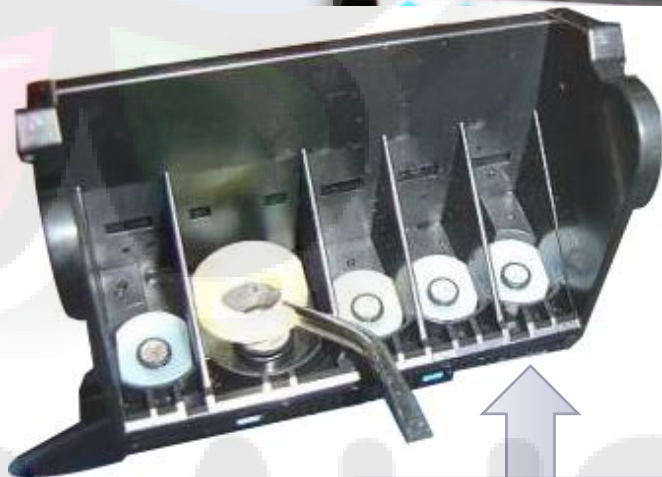

Silicone washers



3. Turn the cartridges so that the orange covers are face-up. Hold the set of cartridges together in one hand so that the chipsets are facing you. Please ensure that the cartridge set is of a higher elevation than the tank unit. Remove the orange cartridge covers using your thumb and fore-finger. Store the covers with the tank plugs from the tank unit. *(You'll also need these if you travel with your CISS)*



4. In the one motion turn the set of cartridges over and install all together into their respective houses in the printer head housing unit. You'll know each cartridge is in its correct place when you've heard it click in, just as if you were installing a Canon original cartridge. Please ensure that you turn over and install the cartridges smoothly and quickly to avoid ink leaking (as pressure may have built up during shipping)

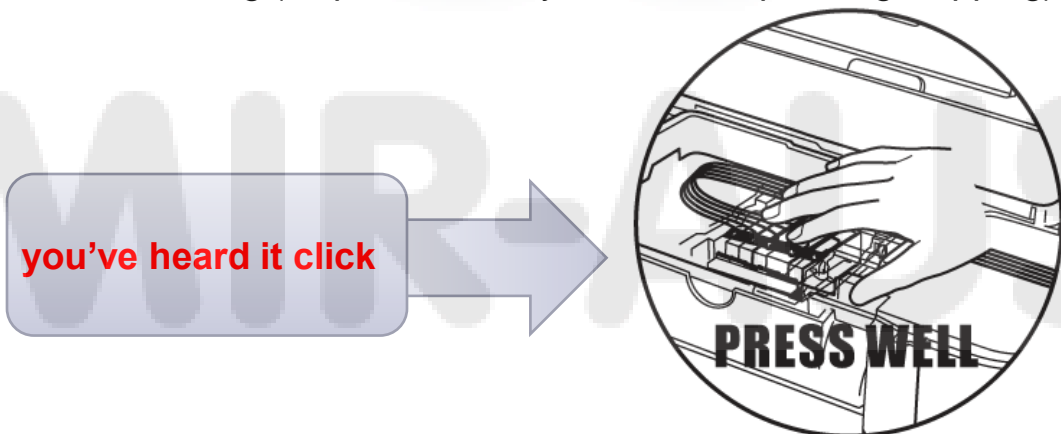

Attaching the ink pipeline to the printer

1. In your packaging we've sent you three differently shaped ink pipeline holders.

Depending on the printer, you'll need to decide which of these pipeline holders will best fit your printer to ensure that the pipeline is attached to the printer frame above the printer head. You may decide to use one or two of them.

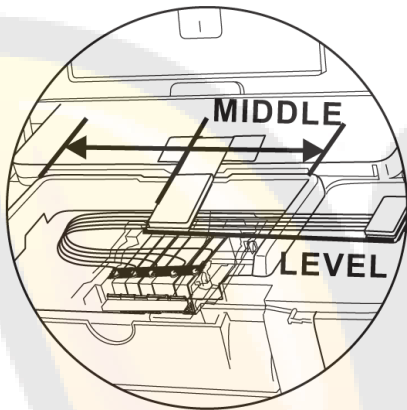
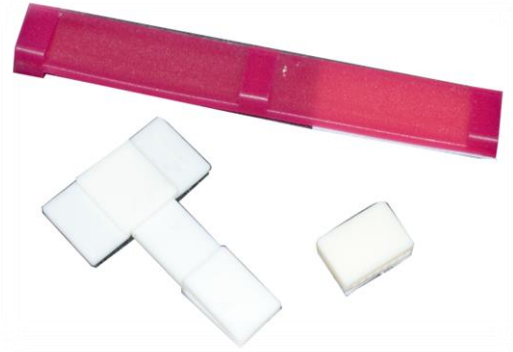

2. The purpose of the ink pipeline holder is to fix a section of the pipeline to the frame so that the ink pipeline will not be damaged nor blocked by the movement of the printer head back and forth.

Test out the best spot before removing the adhesive on the back of the pipeline holder.

Now simply route the tubing out of the printer as you see fit – we think the natural fit is to the right of the printer, but you can experiment to see what works best for you. You may have to mold the included Plastic bracket to suit your needs. In this configuration the lid almost closes completely.

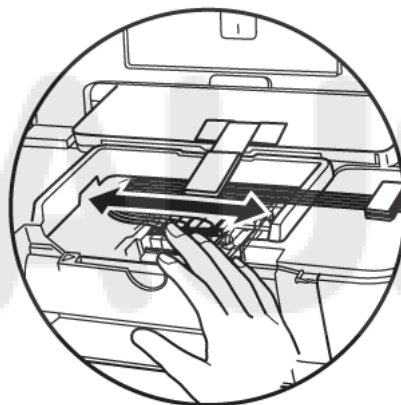
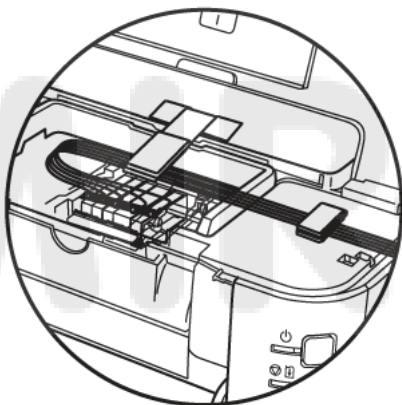

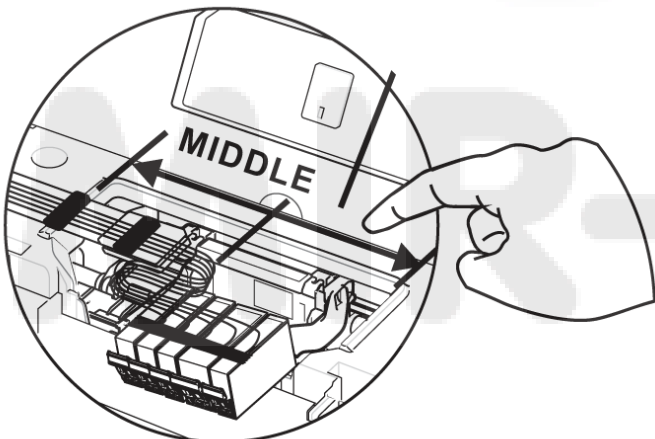
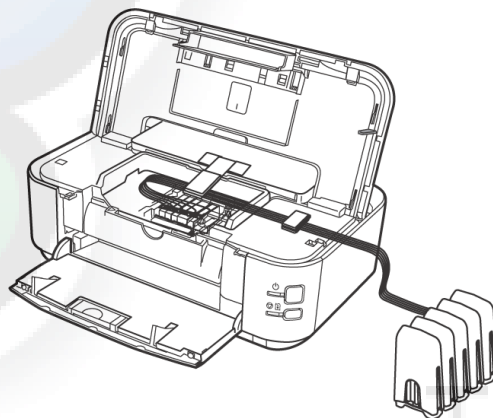
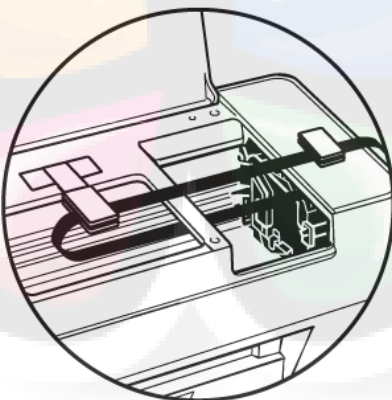
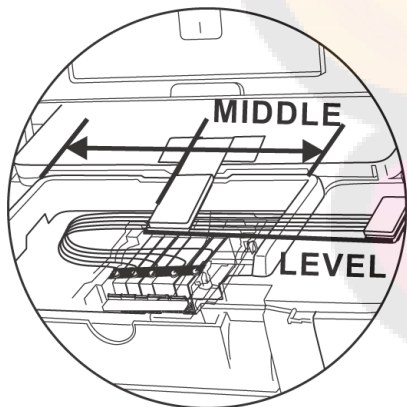
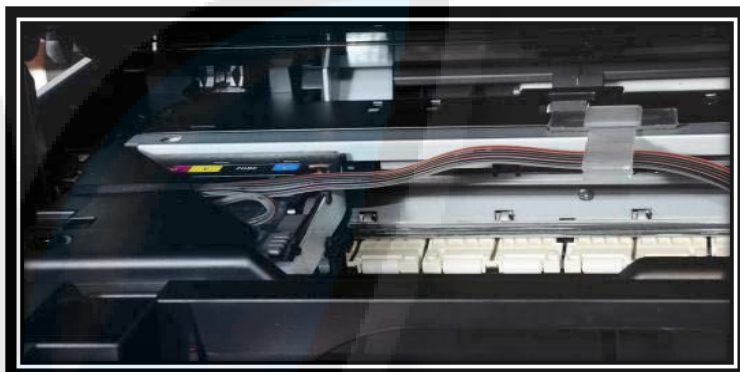
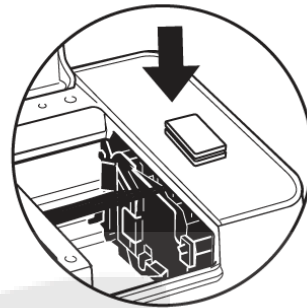
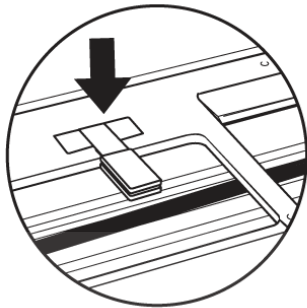
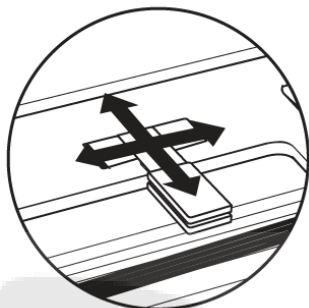
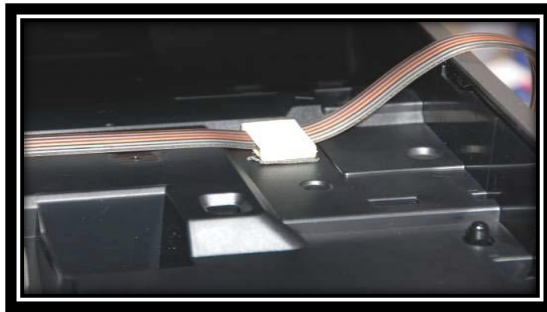
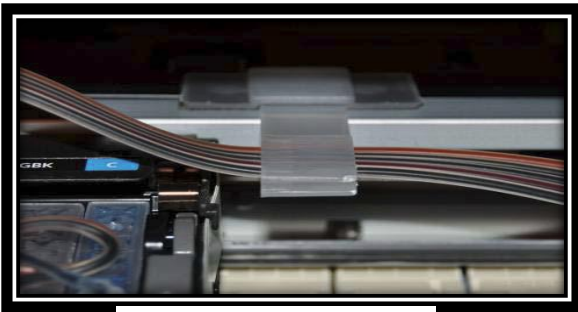

Making the printer think the cover is closed...

The “printer cover latch” needs to be fooled into thinking the printer cover is closed (since the lid cannot be closed with tubing coming out of it) – simply use the small piece of rubber or a **small folded piece of paper (4)** and insert it into the latch area with tweezers.

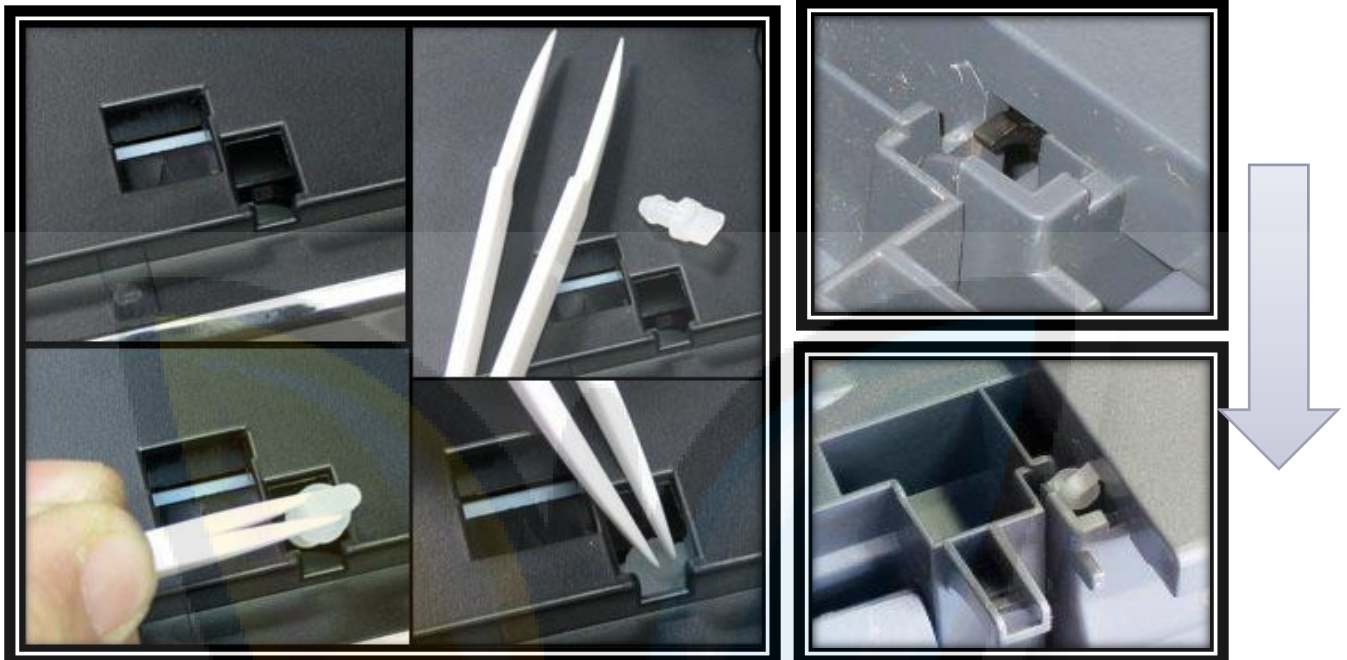

Canon MP500

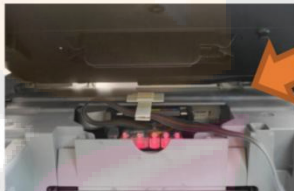

Canon MP640



The printer will now think the printer cover is all-the-way closed, and your printer will function normally. There is the added benefit - a partially closed lid protects the under-side of the print head by keeping dust and particles out of the “print-track”.

Reset cartridges

There are chips on the end of each cartridge which have a 'memory' of how much ink you have used.



Printers also have a 'memory' of your usage. These memory systems assume you've run out of ink when you have consumed a certain amount. They don't realise that you have a large external tank feeding your cartridges. So after some time you'll get a message on your PC screen telling you to replace your cartridges.

Check your ink level in the external tanks. Most likely there will still be a ink in these tanks. If this is the case, you'll need to reset the chips.



It is also important that you place the external tanks next to (so level with) your printer.

Don't put them at a higher or lower elevation than your printer as this may affect the flow of your ink from the tanks to the cartridges inside the printer)

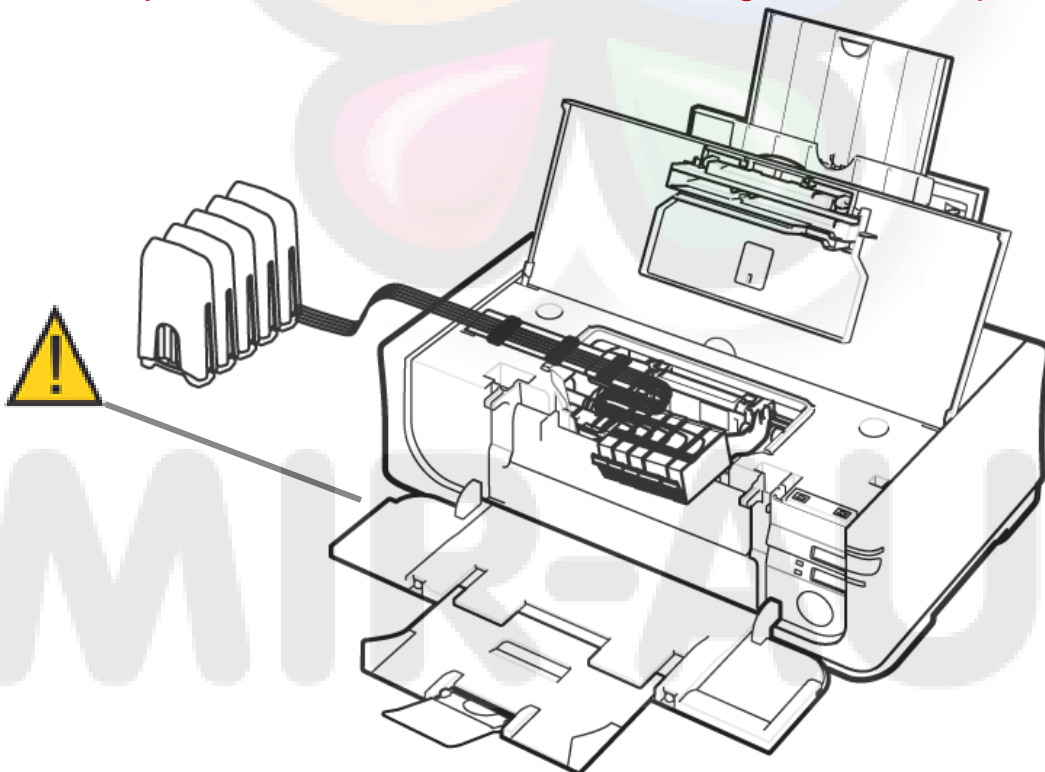

WHO TO RESET THE CHIP-SET



- 1- Power the printer on
- 2- Keep holding the power button
- 3- Open the printer lid
- 4- Remove the door sensor plug
- 5- Keep the lid open for 30 seconds
- 6- Put the door sensor plug back
- 7- Close the printer lid
- 8- Release the power button

